

# WASHINGTON TOWNSHIP 2015

SOUTH PART

LOC. NO.	PARCEL NAME	ACRES	VOL./PG.	LOC. NO.	PARCEL NAME	ACRES	VOL./PG.
AL 1	H.B.K. LEWIS	2.02	286/138	EG 128	V. PALLONE & V. YEAGER	5.06	714/104
AL 2	J. BLANKENSHIP	2.73	174/346	EG 129	F. B. W. CAMPBELL	5.00	382/441
AL 3	"	1.00	"	EH 130	E. B. BENNER	5.01	746/710
BL 4	D. SMITH	1.00	287/379	EH 131	E. B. K. BENNER	5.01	353/346
BL 5	E. B. C. SICKMILLER	1.50	290/400	EG 132	R. B. T. PIPER	5.01	383/374
BK 6	A. B. S. MATTIX	1.00	448/378	EG 133	A. B. R. YODER	5.03	827/471
BK 7	V. ANDERSON	2.10	700/410	EH 134	D. VECCHIARELLI	5.03	620/01
BK 8	D. MATTIX	2.90	349/500	EH 135	C. B. L. MEGGITT	5.24	346/506
BK 9	"	2.68	324/486	EG 136	G. B. S. PACE	5.03	387/280
BK 10	J. B. R. ST. CLAIR	8.39	292/17	EG 137	"	5.03	741/444
AK 11	G. TAYLOR	1.20	348/602	EH 138	S. HUDNALL (ELLIS)	5.45	341/382
AK 12	"	1.86	"	EH 139	J. DAILEY & M. WRIGHT	5.67	688/463
AK 13	G. PANGBORN	0.92	294/697	EG 140	M. B. A. BECKER	5.03	749/316
AK 14	G. B. C. ROGERS	0.81	394/329	EG 141	M. B. A. BECKER	6.00	745/72
CL 15	T. BOSH & J. COOPER	0.89	785/672	EH 142	J. B. L. TROTTER	5.00	805/582
DL 16	THE WALKER FAM. TRUST	0.77	387/142	FG 143	M. B. A. BECKER & K. LEONHART	7.22	396/603
CL 17	L. B. C. BARTLETT	3.19	343/324	FG 144	M. B. A. BECKER	7.22	396/603
CL 18	D. GIBSON	2.59	324/396	FG 145	"	7.40	"
CK 19	D. B. W. FISHER	1.24	145/504	FG 146	R. B. C. GUEGOLD	17.61	676/701
CK 20	W. B. D. FISHER	0.14	377/266				
CL 21	M. B. S. WILLIAMS	13.70	331/25	FG 148	R. B. C. GUEGOLD	3.99	676/701
DK 22	J. B. C. RIZOR	11.22	295/71	FG 149	S. SCHOPP	0.90	385/304
DK 23	C. B. C. RIZOR, JR.	3.65	877/337	FG 150	W. B. R. NELSON	0.25	193/385
DK 24	D. CARTER	13.51	341/391	CJ 151	A. B. K. COLE	4.06	785/413
DK 25	R. C. B. D. CARTER	11.80	351/469	FJ 152	T. S. M. SMITH	5.01	304/639
DK 26	J. NETHERS	1.68	295/727	FJ 153	R. WILLIAMS & S. PEAK	1.66	390/781
CK 27	R. B. F. CRESWELL	3.39	315/283	EJ 154	A. WALKER	1.70	394/267
DK 28	W. D. J. DAVIS	0.74	328/787	AL 155	C. B. L. MARTENEY	1.65	394/626
DK 29	R. B. C. CARTER	6.29	295/878	AL 156	"	5.71	"
EL 30	J. BECK, JR.	2.75	335/324	DH 157	THE SMOTHERMAN FAM. TRUST	2.61	400/430
FL 31	B. LUSK	1.75	301/807	EJ 158	J. WALKER	3.48	601/30
EL 32	J. B. J. WALKER	2.00	297/824	EJ 159	M. GUSTAFSON	5.64	655/787
EK 33	J. B. F. MOLLENKOPF	1.53	699/258	EH 160	W. B. P. KEIL	2.62	683/384
FK 34	D. OILER	2.00	471/979	EH 161	"	2.35	"
AJ 35	T. B. D. RUSH	1.37	325/540	FL 162	J. B. S. FRANCH	0.79	750/903
BJ 36	R. B. M. LEWIS	8.26	388/505				
BJ 37	B. REYNOLDS	8.60	289/670				
AJ 38	L. HOFFMAN	0.85	291/383				
AJ 39	"	1.01	337/40				
BH 40	THE TORPPA K.P. TRUST	2.90	808/368				
BH 41	"	0.21	808/370				
AH 42	V. KUNZE	4.42	387/96				
BH 43	THE SEC. OF H.U.D.	2.28	830/496				
BH 44	V. KUNZE	1.15	780/846				
BH 45	C. LEO	3.90	806/1056				
CJ 46	M. B. M. OWENS	5.17	825/1004				
CJ 47	S. B. R. STROBEL	5.01	753/858				
CJ 48	N. RANDOLPH	5.04	825/240				
CJ 49	R. B. S. BAILEY	5.00	817/229				
CJ 50	"	5.00	728/978				
CJ 51	W. A. CRESWELL	5.05	475/70				
CJ 52	W. A. CRESWELL	5.04	738/884				
CJ 53	THE W. CRESWELL TRUST	0.89	393/832				
CJ 54	W. A. CRESWELL	5.00	738/884				
CJ 55	D. B. L. VANDYKE REV. TRUST	5.14	786/565				
CJ 56	"	5.00	"				
CJ 57	"	5.01	"				
CJ 58	M. FETTERS	5.05	739/584				
DJ 59	L. SHOWALTER	5.00	384/839				
DJ 60	L. SHOWALTER	5.03	449/82				
DJ 61	G. B. L. NEFF	6.71	681/730				
DJ 62	M. B. M. OWENS	6.71	825/1023				
DJ 63	B. B. K. MYERS	6.71	353/816				
DJ 64	W. DRAKE & M. WILLIAMS	5.11	818/104				
DJ 65	J. B. E. FERRELL	5.06	325/462				
DJ 66	V. MITCHELL	5.07	302/158				
DJ 67	R. FRANKS & D. MCGILNTOCK	5.11	386/430				
DJ 68	J. MARTIN	3.43	739/836				
DJ 69	D. B. B. VANDYNE	8.69	734/938				
DJ 70	P. B. E. SNIDER	5.01	354/432				
DJ 71	J. B. D. HINKLE	5.01	343/268				
DJ 72	A. B. R. VILLELLA	5.03	324/882				
DJ 73	J. B. D. HINKLE	5.01	341/827				
DJ 74	E. HEIMLICH ET'AL	1.58	741/214				
DJ 75	B. CRAWFORD	13.33	332/500				
DJ 76	J. ROARK	5.01	374/184				
DJ 77	P. B. K. NOE	5.01	326/448				
DJ 78	R. B. P. RING	5.01	376/592				
DJ 79	P. B. K. NOE	5.01	743/704				
CJ 80	B. B. M. ADAMS	10.71	348/784				
DJ 81	V. STUDDER	9.60	336/370				
DJ 82	S. B. A. MCDORMAN	5.01	394/613				
DJ 83	S. BENYO	9.60	342/547				
DJ 84	S. B. A. MCDORMAN	5.01	394/613				
DJ 85	S. BENYO	10.07	342/545				
DJ 86	P. B. A. STRAHM	5.10	827/716				
DH 87	THE E. DELANEY REV. L.V. TRUST	20.00	764/287				
DH 88	THE SMOTHERMAN FAM. TRUST	5.00	398/758				
DH 89	E. B. L. MURPHY	1.00	348/637				
DH 90	R. MURPHY	2.00	746/531				
EH 91	R. B. J. BREWER	5.00	301/267				
EH 92	D. B. T. REDMOND	1.68	830/1044				
FH 93	J. B. J. TUPPS	2.50	372/810				
FH 94	E. SCHLAHET III	2.50	828/218				
AG 95	S. HARPER	2.63	286/134				
AG 96	S. B. D. HARPER	12.34	308/176				
AG 97	T. B. D. REDICK	0.80	367/738				
AG 98	R. B. S. SNYDER	8.66	397/267				
AG 99	"	5.00	397/245				
AG 100	R. B. T. SNYDER	7.89	390/569				
CG 101	V. KUNZE	5.03	354/555				
DG 102	R. B. J. PREECE	5.00	351/549				
DG 103	P. MORTON	5.00	202/237				
DG 104	W. MORTON	16.39	228/41				
DG 105	D. B. P. FRENCH	17.92	304/228				
DG 106	B. ECKARD	1.00	803/734				
DG 107	C. MILLER	4.00	798/233				
DG 108	S. B. T. STRICKLER	5.02	604/827				
DG 109	"	5.03	"				
DG 110	W. B. J. MORTON	5.05	279/871				
DG 111	"	5.71	279/875				
DG 112	"	2.25	"				
DG 113	"	2.21	"				
DG 114	"	2.21	"				
DG 115	G. B. B. GROHOSKI	2.46	832/568				
DG 116	M. AULT	3.00	784/160				
DG 117	G. A. BROWN, II	1.00	360/549				
DG 118	C. AISEL	1.25	694/682				
DG 119	G. B. S. JONES, JR.	13.66	759/491				
DG 120	D. BERRY	1.00	702/162				
EM 121	P. B. M. CRAIG	5.18	800/267				
EM 122	"	5.24	"				
EM 123	L. MADDOCK & M. SPADE	5.24	800/279				
EH 124	T. CHAN	5.39	809/277				
EG 125	R. STEPHENSON	5.02	771/1014				
EG 126	H. GUINER	5.02	781/121				
EG 127	J. DAILEY	5.04	790/617				

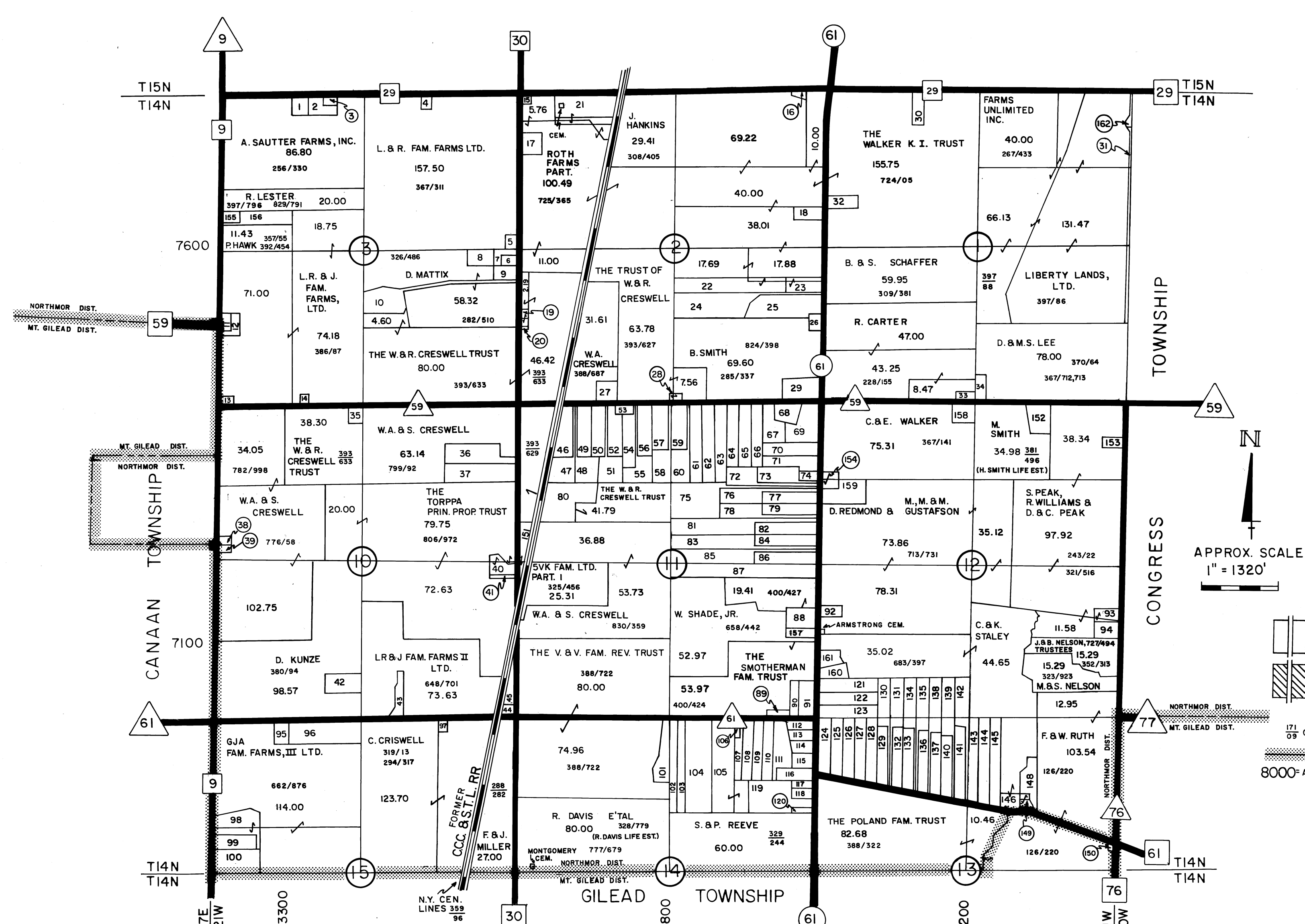

**LEGAL DISCLAIMER:**  
Public information data is furnished by this office with no expressed or implied warranties, concerning the accuracy of this data. This office assumes no liability whatsoever associated with the use or misuse of such data. The property ownership maps are an interpretation of the public records on file in the Morrow County Recorder's Office. The Morrow County Engineer shall be saved harmless from any and all claims arising from the use of the same.

**LEGEND**  
 [Symbol] UNINCORPORATED VILLAGE  
 [Symbol] INCORPORATED VILLAGE  
 [Symbol] SCHOOL DISTRICT BOUNDARY LINE  
 [Symbol] 8000' APPROX. RURAL HOUSE NUMBERING

**APPROX. SCALE**  
1" = 1320'

Prepared by  
Morrow County Engineer's Office  
L. Randy Bush — County Engineer

WASHINGTON TOWNSHIP  
MORROW COUNTY, OHIO  
SOUTH PART

CURRENT AS OF 12/31/14 STRAIN