

SMALL PARCELS

Table with columns: NAME, ACRES, VOL, PG, NAME, ACRES, VOL, PG. Lists parcel owners and their details for sections 1-125 and 126-250.

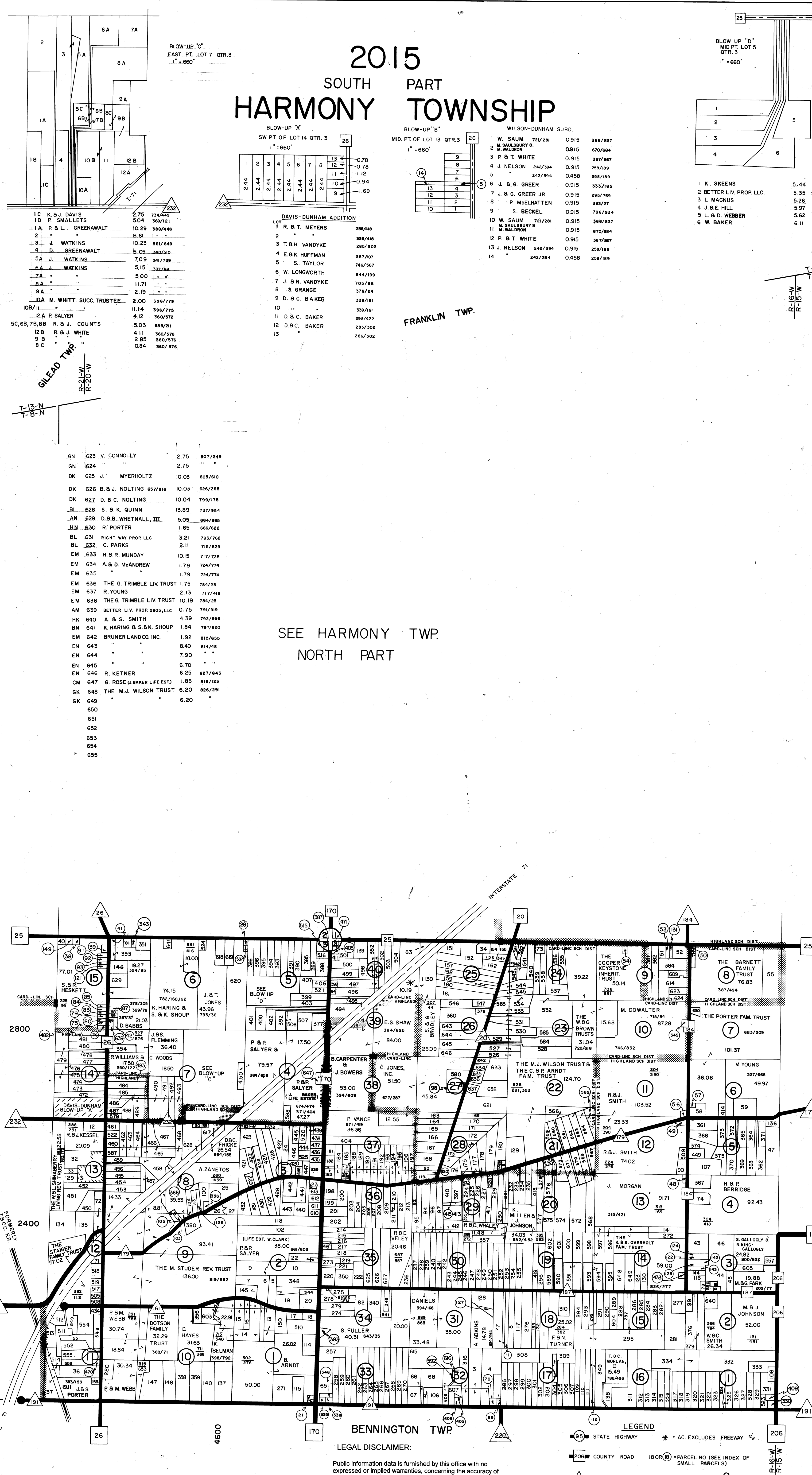

Table with columns: NAME, ACRES, VOL, PG. Continuation of parcel owner information for sections 1-125 and 126-250.

2015 SOUTH PART HARMONY TOWNSHIP

SEE HARMONY TWP. NORTH PART

LEGAL DISCLAIMER: Public information data is furnished by this office with no expressed or implied warranties...

Prepared By: Morrow County Engineer's L.Randy Bush - County Engineer. SOUTH PART 2400 - APPROX. RURAL HOUSE NUMBERS. HARMONY TOWNSHIP MORROW COUNTY, OHIO.