

2015 CARDINGTON TOWNSHIP WEST PART

LOC. NO.	NAME	ACRES	VOL./PG.	LOC. NO.	NAME	ACRES	VOL./PG.	
AU 1	M. ADAMS	3.00	820/935	AN 129	D. BURGALL TRUST	2.00	373/478	
AU 2	C. B. M. GALLOWAY	1.34	334/261	AN 130	M.B.M. YAKE	2.98	363/478	
BU 3	D. BOLES	2.00	365/229	BN 131	M. YAKE	2.55	356/504	
BU 4	"	2.01	365/231	BN 132	J. HARMON	2.48	353/31	
BU 5	E. B. M. EDWARDS	5.19	282/234	BN 133	R. B. W. FRANCO	1.83	358/330	
BU 6	D. B. R. DICKERSON	2.00	345/233	CN 134	R. VANCE	2.32	789/877	
CU 7	D. B. R. BARKER	3.00	482/103	DN 135	T. SKINNER	2.99	210/116	
CU 8	"	12.50	"	"	"	"	"	
AU 9	D. B. M. HILL	1.00	299/516	"	"	"	"	
AU 10	M. B. R. SNOW	4.41	797/335	DN 138	J. B. R. CASTLE	5.01	348/85	
AT 11	N. CLAUSIS	1.94	254/38	DN 139	H. GOODMAN	5.02	750/747	
BT 12	R. B. P. LINDER	0.57	200/175	DN 140	D. MARQUARDT	1.54	615/604	
AT 13	J.P.MORGAN CHASE BANK, NA	1.27	750/948	DN 141	R. S. ROSE	0.91	368/746	
BT 14	H. DUTT	1.50	692/268	DN 142	THE STEPHENS KEYSTONE INHERIT TRUST	2.78	703/332	
BU 15	P. KACSALA	15.30	645/421	DN 143	C. MAY	1.65	691/244	
CU 16	J. T. B. RENSCH	2.00	400/650	DN 144	W. V. GOODMAN	16.96	724/105	
DU 17	A. S. CAREY	9.00	715/104	DN 145	FIRST FED. BANK OF OHIO	2.48	826/1015	
DT 18	C. B. M. L. JENKINS	5.00	345/778	DN 146	MORROW CO. COON HUNTER'S ASSN.	9.03	220/181	
DT 19	C. B. R. DIAQUE	2.00	600/460	"	"	"	"	
BL 20	R. L. WITHER	2.50	728/571	AM 148	D. B. N. BURGALL TRUST	7.33	609/312	
AS 21	M. L. LUTHEZ & D. MARSDI	5.00	785/967	AM 149	W. WIGTON	2.27	378/287	
AS 22	THE CROWLE LIV TRUST	1.02	829/932	CM 150	D. B. S. WARNER	2.05	708/681	
AS 23	"	0.19	"	BL 151	M. GRAHAM	1.69	627/240	
AS 24	C. B. J. SLUSHER	7.50/850	5.00	319/322	BM 152	J. CARRIGAN	1.77	688/468
BS 25	B. SECKEL	5.03	665/957	BM 153	W. V. GOODMAN	2.00	319/372	
BS 26	"	3.04	"	CM 154	D. B. S. SMITH	1.53	368/586	
BS 27	A. ORECCHIO	7.14	773/85	BM 155	W. V. GOODMAN	14.14	391/232	
BS 28	E. FEASEL	2.61	373/286	CM 156	D. B. S. WARNER	2.00	705/621	
BS 29	J. B. T. CROMWELL	7.14	638/917	CM 157	T. POORMAN	10.54	165/299	
BS 30	"	2.61	"	CM 158	THE GREEN K.I. TRUST	2.00	759/137	
BS 31	W. B. S. SMITH	5.41	350/651	CM 159	"	2.00	"	
BS 32	"	5.48	"	CM 160	M. DISTERDICK	6.83	773/323	
BS 33	K. B. P. MCCARTY	5.55	380/758	CM 161	C. COURTNEY	10.83	368/208	
BS 34	THE YAKE FAM. TRUST	5.63	367/805	DN 162	K. B. M. SEAVOLT, II	4.38	786/188	
BS 35	E. B. S. OSBORNE	1.15	361/50	DN 163	D. B. D. SEVERNS	4.75	763/01	
BS 36	F. OSBORNE	5.13	801/380	DN 164	THE MILLER FAM. TRUST	4.94	679/735	
BS 37	E. B. S. OSBORNE	5.30	744/232	DN 165	R. CARDER	4.74	377/289	
CS 38	J. K. BUSH	1.00	691/977	DN 166	MCCARTY PROP. LLC	0.01	"	
CS 39	D. B. P. WOOD	0.38	234/883	DN 167	"	13.00	"	
CS 40	"	1.57	"	DN 168	"	20.35	392/138	
DS 41	J. MULLINS	1.03	236/287	DN 169	C. B. P. ALBRIGHT	9.46	200/384	
AR 42	T. P. BLANKENSHIP	5.34	281/228	DN 170	A. GOODMAN	24.97	341/460	
AR 43	D. A. CONGROVE	0.77	658/885	BL 171	G. B. K. GOODMAN	3.23	825/454	
AR 44	D. RADIGER, SR. & B. LUCIUS	0.77	344/710	CM 172	L. B. P. GEORGE	1.00	349/709	
AR 45	R. C. H. ROWE	0.77	822/845	CM 173	"	0.51	"	
BR 46	P. B. J. KIRK	7.67	692/726	CM 174	D. B. J. BROOKS	6.02	315/648	
BR 47	J. B. P. KIRK	2.32	688/133	CM 175	G. WILLIAMSON	3.47	298/177	
BR 48	T. B. N. WALTERS	0.97	818/443	AL 176	E. B. N. HUGHES	7.26	348/237	
BR 49	H. S. T. WALTERS, LIFE EST.	18.88	818/440	AL 177	B. STRAIT	1.65	700/203	
DR 50	E. S. T. HIBAR	4.00	344/488	BL 178	S. MANIACI	1.00	747/231	
DR 51	"	2.00	344/487	BL 179	L. GULLETT	1.00	746/996	
DR 52	L. B. P. REED	1.00	342/764	BL 180	R. B. J. FOUST	2.30	327/81	
AR 53	D. B. A. HEACOCK	1.65	714/267	BL 181	THE BEJE FARM TRUST	1.67	777/1033	
DR 54	J. B. C. CURRY, JR.	5.00	341/510	BL 182	D. PETERS, JR. & K. LINDER	1.34	368/289	
AQ 55	R. P. P. FIELER	0.76	229/71	BL 183	R. NIDA	1.75	245/134	
AQ 56	T. PATRICK DIETER	0.76	378/205	BL 184	R. LOWTHER	12.50	728/571	
AQ 57	M. EBERT	0.76	308/407	CL 185	R. D. WHEELER	1.47	356/28	
AQ 58	R. HIGGINS	0.79	787/288	CL 186	R. WAGNER	2.01	332/444	
AQ 59	THE COOK FAM. TRUST	0.79	714/387	CL 187	J. CHRISTIAN	1.30	689/200	
AQ 60	R. B. J. MAHAFFEY	0.79	238/187	BL 188	THE BEJE FARM TRUST	13.72	777/1033	
AQ 61	M. JARVIS	0.79	326/717	CL 189	C. B. J. LINKOUS	1.98	364/647	
AQ 62	THE GREEN C. I. PROP. TRUST	0.79	748/240	CL 190	THE FAUST K. I. TRUST	9.15	740/440	
AQ 63	T. NYE	1.50	699/472	DL 191	M. LOVER	771/332	3.49	348/242
AQ 64	L. B. P. DOTSON	0.74	372/193	DL 192	B. B. R. WEBER	1.00	338/640	
AQ 65	J.P.MORGAN CHASE BANK	0.75	821/445	DL 193	J. SMITH	797/372	0.78	231/619
AQ 66	W. B. C. TIMMONS	2.38	248/641	DL 194	W. B. K. SEAGLE	0.78	778/291,293	
AP 67	G. D. DAVIS	1.71	794/1047	DL 195	C. T. WOODY BAGWELL, JR.	3.75	365/378	
AP 68	THE DAVIS FAM. REV. LIV. TRUST	5.28	614/610	DL 196	D. L. HESSER	5.00	744/228	
BP 69	S. JACKSON	5.10	788/281	DL 197	K. B. A. VETTERS	5.00	626/21	
CQ 70	C. B. PETERSON	5.10	775/715	DL 198	J. B. M. WEISS	1.02	811/988	
CQ 71	"	4.64	"	DL 199	N. BEATTY	1.13	377/881	
CQ 72	D. WILLIAMS	5.10	394/912	DL 200	J. B. R. ABRAM	0.98	346/714	
CQ 73	"	4.65	"	DL 201	"	1.00	"	
CQ 74	"	5.53	"	DM 202	C. DAVIS, II	1.42	368/265	
CQ 75	"	5.01	"	DM 203	M. COLEMAN	1.14	343/241	
CQ 76	E. B. N. REED	5.53	678/648	DL 204	D. B. S. HICKMAN	2.06	343/737	
CQ 77	"	5.02	684/974	DM 205	THE WANSIE O'LEARY HOAN MORTGAGE TRUST	1.51	686/955	
CQ 78	R. B. G. SHELDON, SR.	1.00	324/823	CM 206	G. B. K. GOODMAN	4.45	803/40	
CQ 79	K. A. D. BEVERIDGE	0.76	358/780	"	"	"	"	
CQ 80	"	2.00	371/236	"	"	"	"	
CQ 81	R. CARPENTER	2.00	330/440	"	"	"	"	
CQ 82	L. BEVERIDGE, SR.	2.00	344/904	"	"	"	"	
CQ 83	B. B. R. NICHOLLS	2.16	764/168	"	"	"	"	
CQ 84	S. BEVERIDGE	2.00	633/148	"	"	"	"	
CQ 85	A. KING	4.00	387/892	"	"	"	"	
CQ 86	C. MILLER, JR. (LIFE EST.)	3.04	740/254	"	"	"	"	
CQ 87	G. HILL	3.04	757/339	"	"	"	"	
DM 88	N. B. K. COCHRAN	3.00	678/01	"	"	"	"	
CQ 89	T. CUSICK	10.54	302/601	"	"	"	"	
CQ 90	"	0.73	288/123	"	"	"	"	
CQ 91	K. BEVERIDGE	2.00	302/751	"	"	"	"	
CQ 92	S. BAKER	2.75	374/233	"	"	"	"	
DQ 93	L. B. A. BEVERIDGE, JR.	6.08	355/644	"	"	"	"	
DQ 94	L. WINCHELL KEYSTONE INHERIT TRUST	1.00	670/78	"	"	"	"	
DQ 95	J. WOODRUFF (LIFE EST. & TRUST)	1.50	672/743	"	"	"	"	
AQ 96	C. B. S. (KAEHLER) GIVENS	1.18	304/784	"	"	"	"	
AQ 97	"	3.04	306/581	"	"	"	"	
AP 98	D. B. J. HEACOCK	0.69	256/505	"	"	"	"	
CM 99	R. B. P. COOK	1.99	719/643	"	"	"	"	
BP 100	R. JURY, II	2.00	347/82	"	"	"	"	
CP 101	D. SNYDER & K. WINCH	3.49	363/524	"	"	"	"	
DP 102	G. B. T. PATRICK DIETER	2.11	358/217	"	"	"	"	
DP 103	Y. B. H. JR. SCARBERRY	2.89	807/447	"	"	"	"	
DP 104	M. B. M. HAUGHT	3.85	731/030	"	"	"	"	
DP 105	M. B. M. HAUGHT	2.00	357/286	"	"	"	"	
BO 106	F. L. EBERT	1.00	282/282	"	"	"	"	
BO 107	THE BEJE FARM TRUST	1.65	773/1023	"	"	"	"	
BO 108	A. CRUM	2.91	393/728	"	"	"	"	
BO 109	B. C. DOUBIKIN	1.33	328/421	"	"	"	"	
BO 110	M. B. J. A. CURTIS	2.97	354/101	"	"	"	"	
AO 111	FANNIE MAE	3.00	824/71	"	"	"	"	
AO 112	R. JAMES	2.12	331/254	"	"	"	"	
AO 113	H. RAMSEY	4.34	772/319	"	"	"	"	
AO 114	R. B. L. JAMES	6.05	736/138	"	"	"	"	
BO 115	T. JONES	1.14	818/243	"	"	"	"	
BO 116	D. TOWNSEND	1.14	380/731	"	"	"	"	
BO 117	C. B. L. TUMEO, JR.	1.14	825/448	"	"	"	"	
BO 118	K. E. KEBERREY & T. WHITE	1.70	601/649	"	"	"	"	
BO 119	R. B. BAYLES, JR.	1.70	687/508	"	"	"	"	
BO 120	K. HENRY	1.14	364/291	"	"	"	"	
DN 121	C. O'BRIEN	5.07	377/872	"	"	"	"	
AN 122	L. THOMPSON	3.28	367/608	"	"	"	"	
AN 123	"	3.36	"	"	"	"	"	
AN 124	C. CALDWELL	2.47	782/561	"	"	"	"	
BN 125	L. B. T. RADEL	7.65	328/286	"	"	"	"	
BN 126	S. B. D. STEPHENS	1.50	812/399	"	"	"	"	
CN 127	D. B. D. BOWERSMITH	1.25	687/355	"	"	"	"	
AN 128	C. HEACOCK & K. SUTTON (LIFE EST.)	5.00	810/958	"	"	"	"	

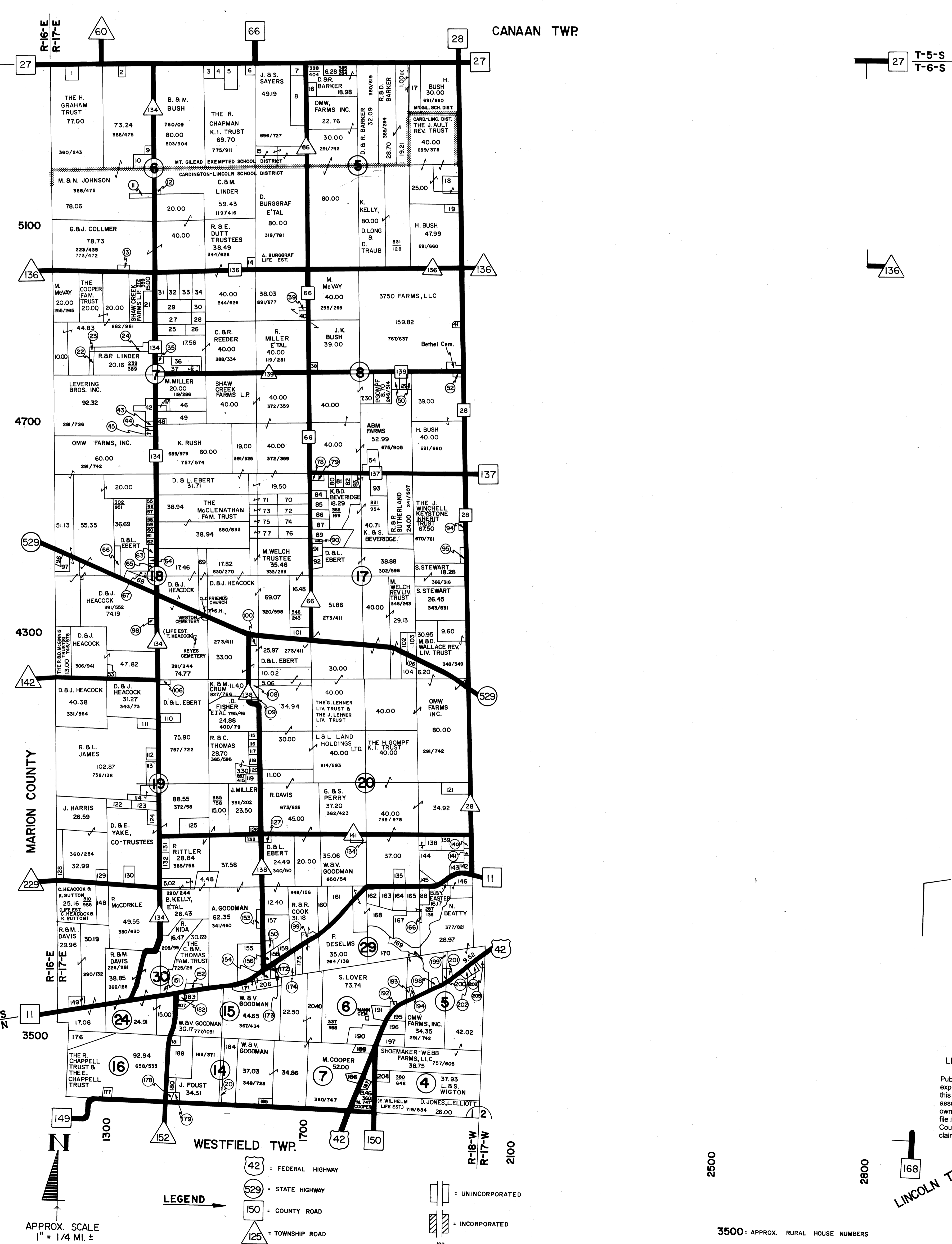

LEGAL DISCLAIMER:
Public information data is furnished by this office with no expressed or implied warranties, concerning the accuracy of this data. This office assumes no liability whatsoever associated with the use or misuse of such data. The property ownership maps are an interpretation of the public records on file in the Morrow County Recorder's Office. The Morrow County Engineer shall be saved harmless from any and all claims arising from the use of the same.

Prepared by
Morrow County Engineer's Office
L. Randy Bush - County Engineer

**WEST PART
CARDINGTON TOWNSHIP**
MORROW COUNTY, OHIO