

BENNINGTON TOWNSHIP 2015

WEST PART

NOTE: ON JAN. 11, 2008 THE INCORPORATED VILLAGE OF MARENGO ELECTED TO CREATE A NEW TOWNSHIP EQUIVALENT TO THEIR CURRENT VILLAGE BOUNDARIES TO BE KNOWN AS "BIG WALNUT TOWNSHIP" MORROW COUNTY, OH. RECORDED JAN. 11, 2008. O.R. 667 PG. 423 P.B. 8 PG. 25 (RECORDER'S OFFICE)

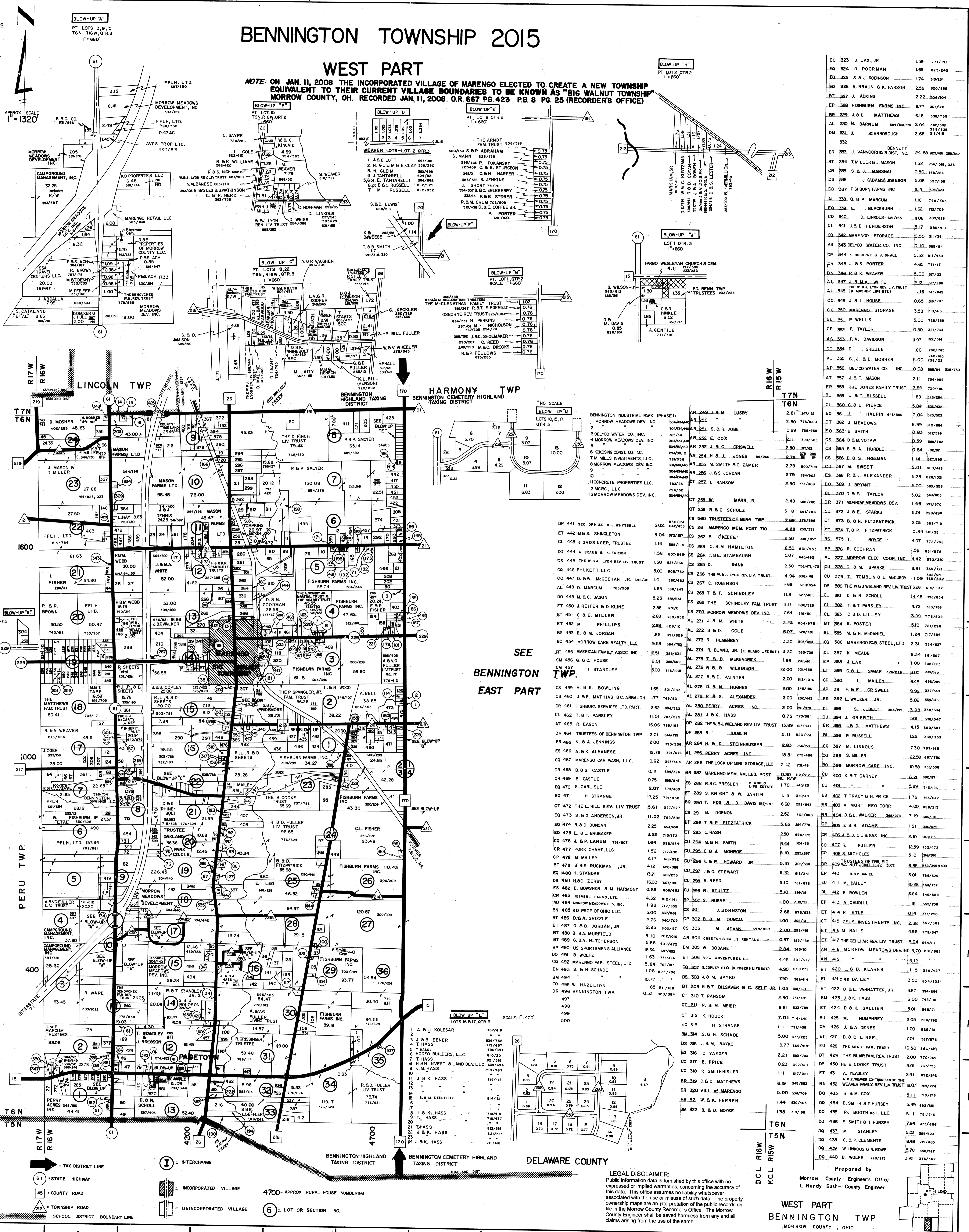

LOC. NO.	NAME	AC.	VOL/PG.	LOC. NO.	NAME	AC.	VOL/PG.	
EQ 1	C. O'BRYAN	1.20	618/256	AP 125	R. C. ALRED	2.00	34/69	
EQ 2		1.20	618/256	CN 126	THE W.B. LYON REV. LIV. TRUST	1.24	636/146	
ES 3	J. FOX 382/234	0.76	304/746	CO 127	R. BROWN	1.95	343/68	
DR 4	C. HUYLER & DAVIS	0.97	688/84	AP 128	D. FAGAN	2.02	605/905	
DR 5	G.A.K. KLEPTACH	1.26	340/142	CM 129	J. B.A. DENES	1.10	425/81	
DR 6	B. & S. CASTLE	1.25	396/140	ES 130	C. MOWERS 678/93	4.99	347/97	
DR 7	E. YOUNG	0.74	340/170	CR 131	J. BEHNER	0.40	631/271	
DR 8	J. & B. PERKINS 274/490	0.74	341/227	ES 132	L. ARBAUGH 397/208	1.00	238/265	
EU 9	P. LITTLE	1.00	309/946	CN 133	THE S. NAGY, IX LIV. TRUST	1.50	703/35	
DS 10	J. LYONS	3.00	240/96	CM 134	T. HASS & C. WANNER	4.10	626/73	
DT 11	D. & D. CLINEDINST	2.00	669/60	CM 135	J.R. PORTER 823/322	7.62	397/64	
DT 12	THE BLAIR FARM REV. TRUST	6.15	770/669	CM 136	M. STANCO & M. HUSCH	7.41	375/614	
ET 13	D. & J. CHERVANK	3.98	340/302	DN 137		5.06	376/444	
EU 14	M. KOESTERMAN	0.78	218/219	CM 138	J. STEVENS	6.28	615/415	
BU 15	A. KOESTERMAN & JACKSON	1.49	349/80	DN 139		6.43	-	
BU 16	THE W.B. LYON REV. LIV. TRUST	1.00	636/146	DM 140	P. DICKERSON	5.34	742/46	
BT 17	S. & D. LEWIS	1.98	394/238	CM 141		9.11	-	
BU 18	L. & J. DAMSON	3.13	772/149	DM 142		6.01	-	
CU 19	D. BREWSTER	2.33	805/857	CM 143		6.09	-	
CU 20	G. & D. GRIZZLE C. & H. HERRICK	2.12	732/370	CS 144	SCHMITZ BROS.	4.18	745/669	
CT 21	J. LEONARD	1.00	447/443	DN 145	J. ADKINS	1.62	311/429	
BU 22	E. B. M. ADKINS, JR.	6.01	397/54	BL 146	T. B. WILSON	5.00	278/406	
BT 23	R. BRASEL	8.77	254/61	CM 147	G. & C. HOUSE	6.51	282/235	
BT 24	S. & D. LEWIS	8.01	290/678	CU 152	MASON FARMS LTD.	6.82	710/624	
CT 25	MARENGO CEM.	4.30	-	AS 149	THE W.B. LYON REV. LIV. TRUST	2.34	636/146	
CS 26	V. RANK	4.33	647/654	CP 150	R. & B. MARCUS	1.01	649/445	
BS 27	R. SONN, JR.	5.99	323/444	CR 151	B. & C. DAMRON	3.54	277/203	
BS 28	THE W.B. LYON REV. LIV. TRUST	4.00	636/146	CU 152	B. CASTLE	2.00	284/23	
CT 29	T. RANSOM	5.81	717/409	CR 153	T. & T. SAUNDERS	5.14	373/568	
CS 30	B. & M. VOTAW	5.70	340/782	EU 155	C. FITZPATRICK	2.22	802/470	
BR 31	REALTY INCOME PROP. 250LLC1	1.00	604/885	CU 156	B. PRICE	0.60	397/581	
BR 32	MORROW MEADOWS DEV. INC.	4.33	313/35	AG 157	S. DAVIS	4.98	774/772	
CR 33	D. HARRIS & C. HARRIS	1.11	725/639	BU 159	P. SIMMONS	6.00	387/471	
AN 34	MORROW MEADOWS DEV. INC.	0.66	684/230	EU 160	T. S. MARTIN	0.77	242/135	
CP 35	D. & C. DANIEL I.	0.45	376/27	BT 161	J. & V. BROWN	6.62	349/485	
BR 36	W. LYON	0.99	384/490	AL 162	THE CARSON FAMILY TRUST	1.00	374/440	
CR 37	R. & W. FARWOOD	1.50	633/61	ES 163	B. & S. CASTLE	2.00	304/540	
CR 38	W. L. M.	1.00	387/768	BM 164	U. B. MARCUS TRUSTEES	0.99	344/549	
CR 39	S. & F. SNYDER	0.89	130/39	ES 165	J. M. BAYKO	4.04	385/682	
BR 40	E. B. M. ADKINS, JR.	0.75	392/657	CU 166	A. B. HOLLER, JR.	0.67	630/274	
CR 41	J. E. M. HUNTER	1.00	392/665	AT 167	R. EAGAN	1.00	294/753	
CO 42	M. ROBERTS	12.87	308/238	DR 168	BENN. AREA DEVEL.	1.00	294/753	
CO 43	R. FISHER 747/16	17.00	723/43	BM 169	J. W. B. K. HASS	12.14	744/810	
AS 44	D. WEBB	2.00	802/717	ET 170	L. RASH	2.50	690/175	
AL 45	THE SHUSTER K.P. TRUST	2.00	622/111	ES 171	S. JOHNSON	0.80	385/359	
BL 46	U. B. MARCUS TRUSTEES	0.90	343/549	ES 172	D. STILLWELL	0.80	685/030	
BL 47	H. MOTZ	5.00	831/855	ES 173	L. SAGAR	0.78	307/675	
BL 48	U. B. MARCUS TRUSTEES	4.57	344/549	DR 174	B. COOLEY 818/765	0.75	387/776	
BL 49	M. B. BASSETT, JR.	6.92	822/814	DR 175	R. WILLIAMSON	0.75	732/429	
BL 50	H. WULF	0.35	389/457	DS 176	H. & C. ZERBY	18.56	360/789	
AL 51	L. & R. PENN 296/753	9.85	296/753	CO 177	M. HALLY	1.64	244/844	
CO 52	R. & D. SHEETS TRUSTEES	1.87	205/201	ET 178	R. & G. MERRICK	5.00	713/644	
CO 53	J. B. I. HOUSTE 397/907	0.34	135/104	CR 179	M. B. VERNON-MOREHOUSE	1.88	326/436	
CO 54	J. B. I. HOUSTE 397/907	0.34	135/104	CS 180	D. & C. MCKINLEY	2.25	802/774	
BS 55	P. & D. MCCARTY	1.00	393/86	ES 181	R. & M. STAGAR	0.96	397/764	
BO 56	W. & B. LYON	4.67	378/558	ES 182	L. L. SACK	0.77	307/675	
EU 57	S. KNIGHT & W. GARTIN	1.21	340/448	ES 183	G. KELSEY	0.77	635/299	
DT 59	C. DAILEY	7.00	804/815	EQ 184	S. B. K. BENNETT	4.36	652/132	
BM 60	D. & D. FISHER	1.56	749/423	ES 185	B. & D. KING 272/226	2.05	249/86	
BO 62	THE SEAMAN FARM TRUST	15.32	672/16	ES 186	D. DENTY	2.04	742/967	
BR 63	THE W.B. LYON REV. TRUST	1.00	636/146	ES 187	E. K. BOWSER	0.61	278/281/320/2	
AP 64	THE CAREY REV. TRUST	8.27	831/844	AL 188	U. B. MARCUS TRUSTEES	1.07	344/549	
CS 65	D. & C. MCKINLEY	1.52	802/774	AL 189	R. B. & B. RHODAS	2.64	280/799	
AP 66	WM. MCALLISTER	2.00	290/784	CL 190	J. J. WEAVER 323/171	5.01	687/412	
AP 67	F. B. E. CRISWELL	2.00	337/440	ES 191	C. SNAVELY	0.80	723/702	
AP 68	BAPTIST CH. GETH. MISS.	3.00	177/138	ES 192	L. A. FIELDS	0.80	831/463	
AP 69	THE W.B. LYON REV. TRUST	4.19	706/605	ES 193	THE BOWER REV. LIV. TRUST	0.80	693/403	
BP 70	W. B. EARWOOD	1.00	633/724	CL 194	A. TOMLINSON	5.01	718/611	
ES 71	J. M. BAYKO	0.76	374/717	ES 195	R. & M. STECK	1.74	397/704	
BO 72	THE SEAMAN FARM TRUST	4.54	672/16	CS 196	J. & B. HOLBROOK	2.25	284/100	
BO 73	N. PARO CEM.	1.00	633/724	DR 197	E. RODRIGUEZ K.P. TRUST	0.75	811/445	
AM 74	J. HOYE, K. HOY, & J. STONER	15.65	384/82	DR 198	J. ADKINS	3.73	304/304	
BO 75	OAKLAND PK. CON. CLUB	1.32	259/339	CT 199	L. HILL REV. LIVING TRUST	26.76	387/259	
BO 76	W. WILSON	1.06	239/402	CR 200	M. ROBERTS	0.76	348/434	
BL 77	T. & B. WILSON	4.92	307/891	CN 201	J. & V. YOUNG	662/96	3.59	388/235
BL 78	E. WILSON	2.96	307/316	ES 202	E. STORER 317/747	5.00	387/43	
BL 79	M. & C. MARQUEZ	1.62	371/631	BU 203	M. & M. KOESTERMAN	4.72	284/101	
CS 80	S. FIELDS	4.25	338/702	CT 204	M. & C. TWIDY	5.45	281/81	
BL 81	W. STERRIT, JR.	3.65	616/288	EU 205	C. S. DAILEY	7.00	804/1019	
BL 82	W. STERRIT	1.17	613/710	AO 206	G. M. HACK	4.91	338/329	
EP 83	J. & D. CARTER	1.96	648/814	AO 207	BAPTIST CH. GETH. MISS.	4.92	284/340	
CN 84	PAGETOWN CEM.	0.52	-	ES 208	D. MANDERS	5.01	684/487	
CR 85	B. D. MILLER	2.53	683/723	BO 209	H. STRANGE	1.63	791/438	
CO 86	D. & F. CLARK	0.81	317/87	BR 210	B. & P. MOSHER	13.05	603/354	
CO 87	C. C. HURSEY	0.51	284/284	ES 211	J. WOODS	3.80	308/385	
CO 88	S. B. WILSON	0.67	242/242	CT 212	S. D. MATT	5.97	734/408	
CO 89	THE W.B. LYON REV. LIV. TRUST	2.79	749/441	DR 213	MORROW MEADOWS DEV. INC.	0.75	338/31	
CO 90	J. B. A. LILLEY 337/796	1.20	192/120	DR 214	MARENGO AUTO PARTS INC.	0.75	234/379	
CO 91	T. M. TAYLOR	0.79	344/24	DR 215	E. RODRIGUEZ K.P. TRUST	0.75	811/445	
CO 92	J. LANDON	0.50	335/528	CL 216	D. & C. LILLEY	1.01	261/54	
CO 93	J. P. PENNINGTON	1.60	617/770	DL 217	J. & D. KELLETT	6.27	370/189	
EP 94	G. & M. EDEFIELD	1.56	746/493	DL 218	J. DAVIDSON	1.25	804/83	
DP 95	D. & B. PINKERTON	11.40	282/289	EU 219	S. RUSSELL	0.87	297/855	
EQ 96	B. & M. LESKO JR.	0.96	345/659	DR 220	D. HEALY & V. BRUNGT	0.99	297/665	
NO 97	B. CONLEY	5.00	725/173	DR 221	N. B. J. YOUNG	2.85	642/70	
DO 98	J. M. BAYKO	3.35	388/414	CL 222	D. & C. M. FOOS	0.66	642/38	
DO 99	B. & C. LEO	1.80	353/632	CR 223	F. SNYDER	2.31	693/309	
DN 100	R. & S. BISCIOTTI	1.70	245/80	AP 224	W. B. K. HERREN	1.42	830/403	
DN 101	L. MAILEY	2.80	693/372	AP 225	J. B. C. BENNETT	2.87	369/104	
DN 102	THE S. NAGY, IX LIV. TRUST	0.57	737/53	AP 226	C. & D. A. MOORE	2.86	379/411	
DN 103	R. & J. CABANILLAS	4.97	670/49	AP 227	THE MONTROSE FARM LIV. TRUST	5.72	783/387/288	
DN 104	D. FULLER	0.50	253/169	AP 228	J. & C. SHEETS & B. WEISS	2.85	719/54	
DM 105	F. & N. WALKER	4.36	316/335	AP 229	C. RANSOM	2.85	642/70	
DL 106	S. & B. HULLSTON	4.13	633/628	AP 230	M. GRAHAM 637/881	2.84	317/704	
BL 107	THE HONSBY FARM TRUST	0.45	658/92	AP 231	J. & E. ROUSH	2.84	388/478	
CM 108	C. A. DITTY	0.62	249/463	AP 232	J. H. JOHNSON	2.84	633/301	
CM 109	G. & J. ROLOSON	1.37	232/585	AP 233	M. KEARNS & C. BOGGS	2.83	308/473	
CL 110	C. B. STEVENS	8.00	339/27	AP 234	H. STEINHAUSER, JR.	2.83	381/576	
CL 111	D. B. N. RIARS	2.28	314/830	AP 235	GREENLEE CONST. INC.	2.05	345/157	
CR 112	THE W.B. LYON REV. LIV. TRUST	0.23	636/146	AP 236	R. J. BOOTH & S. LLC	1.69	751/748	
CR 113	M. ROBERTS	1.20	343/66	AP 237	J. CORRAO	2.39	682/704	
EQ 114	M. & M. KEMMERLING	1.20	824/261	AP 238	R. & K. HOUCK	0.68	309/476	
EU 115	W. HENNER, III	3.17	604/82	AP 239	D. & D. FISHERMAN 288/773	2.50	289/773	
BP 116	W. LLOYD 356/22	2.00	307/118	AP 240	R. HILL	5.45	361/787	
DM 117	J. & C. GRIFFITH 308/78	2.44	223/287	AP 241		2.62	361/787	
DS 118	J. & M. BAYKO	7.78	388/414	AP 242	C. B. L. ADAMS	2.82	341/251	
DR 119	THE STECK FAMILY TRUST	11.10	805/24	AP 243	H. & F. JACOBS	4.16	315/438	
EO 120	R. & G. LEASE 354/42	2.83	398/840	AP 244	MARENGO CHRISTIAN CH.	2.83	765/566	
AO 121	W. & M. RANCK 339/298	4.95	284/241	AP 245	MARENGO CH. OF CHRIST	5.65	283/689	
AO 122	R. BOSWORTH	4.91	309/76	AP 246	C. SHEARS	2.82	373/796	
CS 123	THE W.B. LYON REV. LIV. TRUST	0.88	636/146	AP 247	J. B. L. LITTLER III	2.81	618/256	
AO 124	L. & M. SMITH	4.85	242/283	AP 248	D. WHEELER	2.81	734/402	

LEGAL DISCLAIMER: Public information data is furnished by this office with no expressed or implied warranties, concerning the accuracy of this data. This office assumes no liability whatsoever associated with the use or misuse of such data. The property ownership maps are an interpretation of the public records on file in the Morrow County Recorder's Office. The Morrow County Engineer shall be saved harmless from any and all claims arising from the use of the same.

Prepared by: Morrow County Engineer's Office
L. Randy Bush - County Engineer

WEST PART
BENNINGTON TWP.
MORROW COUNTY, OHIO

CURRENT AS OF: 12/19/14 B. STRAIN